

Capacities

Rental

| | Dimensions (in sq feet) | Fixed Room Seating | Theater Seating | Banquet Seating | Classroom Seating | Open Square Seating | Up to 4 Hours | Each Additional Hour |
|---|-------------------------|--------------------|-----------------|-----------------|-------------------|---------------------|---------------|----------------------|
| McCloska Auditorium | 3,256 | 165† | 165 | - | - | - | \$350 | \$75 |
| McCloska Ballroom | 2,394 | 200‡ | 150 | 120 | 80 | 40 | \$300 | \$70 |
| Lewis Collens Welcome Center | 1,155 | 60‡ | 40 | 32 | - | - | \$125 | \$25 |
| LaSalle Bank Executive Conference Room | 1,924 | 16* | - | - | - | - | \$85 | \$20 |
| Ephraim Meeting Room 202 | 340 | 12* | - | - | - | - | \$50 | \$10 |
| Chuttke Meeting Room 704 | 323 | 10* | - | - | - | - | \$50 | \$10 |
| Gurtz Meeting Room 705 | 323 | 10* | - | - | - | - | \$50 | \$10 |
| Meeting Room 706 | 323 | 10* | - | - | - | - | \$50 | \$10 |
| Meeting Room 516 | 390 | 16* | - | - | - | - | \$85 | \$20 |
| Pritzker Club Main Floor Dining | 3,526 | 86** | - | - | - | - | \$200 | \$45 |
| Pritzker Club Private Dining Room 605 | | 8* | - | - | - | - | \$50 | \$10 |
| Pritzker Club Private Dining Room 606 | | 12* | - | - | - | - | \$50 | \$10 |
| Pritzker Club Private Dining Room 607 | | 18* | - | - | - | - | \$50 | \$10 |

* Fixed Meeting Table
 ** Standard Pritzker Club Dining Tables
 † Fixed Auditorium Seats
 ‡ Reception

Hermann Hall Conference Center

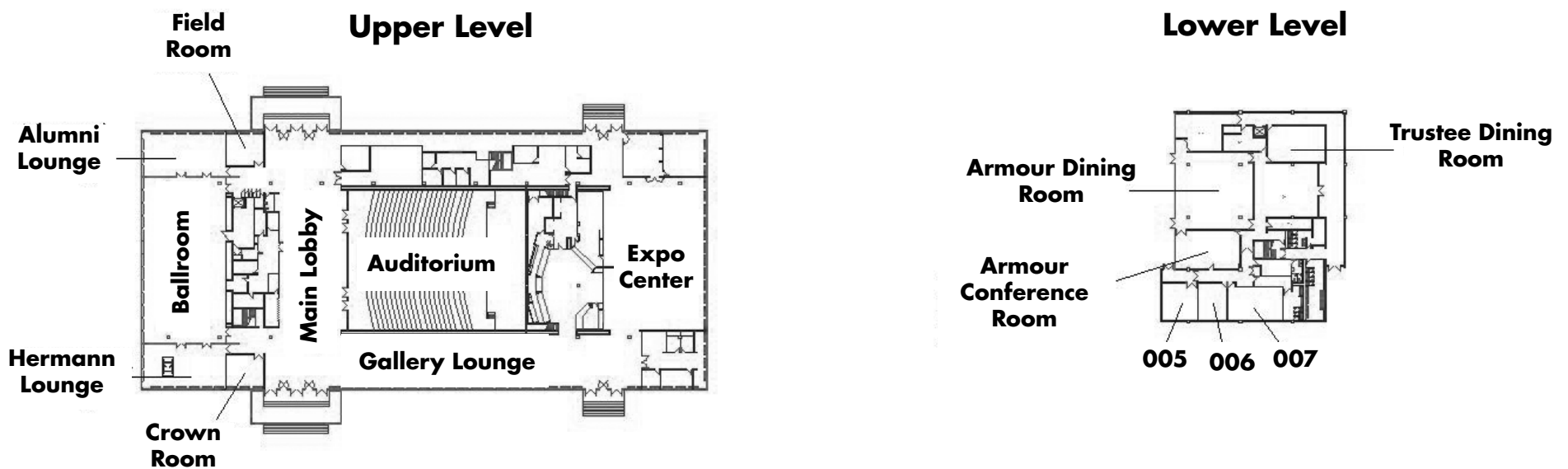

Capacities

Rental

| | Dimensions (in sq feet) | Fixed Room Seating | Theater Seating | Banquet Seating | Classroom Seating | Open Square Seating | Up to 4 Hours | Each Additional Hour |
|---|-------------------------|--------------------|-----------------|-----------------|-------------------|---------------------|---------------|----------------------|
| Upper Level Rooms | | | | | | | | |
| McCormick Auditorium | 9,744 | 836† | 836 | - | - | - | \$600 | \$125 |
| Main Lobby | 8,213 | 200‡ | - | - | - | - | \$240 | \$60 |
| Exposition Center | 6,240 | - | 300 | 300 | 140 | 48 | \$375 | \$90 |
| McCormick Ballroom | 5,000 | - | 300 | 300 | 140 | 48 | \$375 | \$90 |
| Gallery Lounge | 4,704 | 200‡ | - | - | - | - | \$240 | \$60 |
| Hermann Lounge | 1,350 | - | 40 | 40 | 20 | 20 | \$85 | \$20 |
| Alumni Lounge | 1,350 | - | 50 | 48 | 30 | 40 | \$85 | \$20 |
| Crown Room | 483 | 20* | - | - | - | - | \$65 | \$15 |
| Field Room | 483 | 16* | - | - | - | - | \$65 | \$15 |
| Lower Level Rooms | | | | | | | | |
| Faculty Club: Armour Dining Room | 2,209 | - | 100 | 100 | 60 | 40 | \$120 | \$30 |
| Faculty Club: Armour Conference Room | 936 | 16* | - | - | - | - | \$85 | \$20 |
| Faculty Club: Trustee Dining Room | 874 | - | 40 | 40 | 30 | 30 | \$85 | \$20 |
| Faculty Club: Room 006 | 759 | - | 20 | 16 | 20 | 20 | \$65 | \$15 |
| Faculty Club: Room 007 | 759 | - | 35 | 32 | 30 | 20 | \$65 | \$15 |
| Faculty Club: Room 005 | 552 | 12* | - | - | - | - | \$65 | \$15 |

* Fixed Meeting Table
 † Fixed Auditorium Seats
 ‡ Reception

Check with your event coordinator regarding the availability of classrooms and lecture halls for your event.